

SPECIFICATION

受 控

临时规格书

Customer : QUARTZ

Applied To :

Product Name : SPEAKER



Model Name : KP5075SP1R50-7561

Drawing No. : KFC7561

Signature of Appronal

--

Signature of KEPO

Approved by	Checkde by	Issued by	Date
			

宁波凯普电子有限公司



Ningbo Kepo Electronics Co.,Ltd.

宁波东钱湖镇东钱湖工业区宝源路 25 号

TEL:+86-574-88370330 FAX:+86-574-88370329

No.25 Baoyuan road Dongqian Lake, Industry Area, Dongqian town,Ningbo City,

China(Post Code:315121)

Sales@chinaacoustic.com www.chinaacoustic.com

Specification for Speaker	Page	2/9
	Revision No.	1.1
Model No. : KP5075SP1R50-7561	Drawing No.	KFC7561

CONTENTS

1. Scope
2. General
3. Electrical and Acoustic Characteristics.
4. Reliability Test
5. Measurement Block Diagram & Response curve
6. Structure
7. Dimensions
8. Packing
9. Revision

Specification for Speaker

Page

3/9

Revision No.

1.1

Model No. : KP5075SP1R50-7561

Drawing No.

KFC7561

1. Scope

This specification is applied to the dynamic speaker which is used all of the electrical acoustic product.

-- compact, rich sound

-- applications: mobile phone, PDA, notebook computer, etc. ..

2. General

2.1 Out-Diameter : 50 mm

2.2 Height : 7.5 mm

2.3 Weight : 13 g

2.4 Operating Temperature range:

-20 ~+60 °C without loss of function

2.5 Store Temperature range:

-30 ~+75 °C without loss of function

3. Electrical and Acoustic Characteristics.

Test condition : 15 ~ 35 °C, 25% ~ 85% RH, 860~1060 mbar

No	Items	Specification
1	Impedance	50 Ω \pm 15% (1Vrms at 1.5KHz)
2	Sound Pressure Level	90 dB \pm 3dB (0.1w/0.1m at average 0.8,1.0,1.2,1.5KHz)
3	Resonance Frequency	450 Hz \pm 20%
4	Frequency Range	Fo ~3.5KHz
5	Input Power	Rated 0.5 W / Max. 0.6 W
6	Distortion	5% Max. at 1kHz/3.54Vrms
7	Buzz and Rattle	Should not be audible buzzes,rattles when the 5V sine wave signal swept at frequency range.
8	Polarity	When supplied plus D.C. voltage to (+) terminal, the cone diaphragm must move to forward.

Specification for Speaker

Page

4/9

Revision No.

1.1

Model No. : KP5075SP1R50-7561

Drawing No.

KFC7561

4. Reliability Test

After test(1~7item), the speaker S.P.L . difference shall be within $\pm 3\text{dB}$, and the appearance not exist any change to be harmful to normal operation (e.g. cracks,rusts,damages and especially distortion).

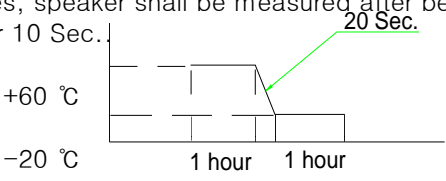
No	Items	Specification
1	High Temperature Test	After being placed in a chamber with $+75 \pm 3 \text{ }^\circ\text{C}$ for 96 hours and then being placed in natural condition for 1 hour, speaker shall be measured.
2	Low Temperature Test	After being placed in a chamber with $-30 \pm 3 \text{ }^\circ\text{C}$ for 96 hours and then being placed in natural condition for 1 hour, speaker shall be measured.
3	Humidity Test	After being placed in a chamber with 85 to 90%R.H. at $+40 \pm 2 \text{ }^\circ\text{C}$ for 96 hours and then being placed in natural condition for 1 hour, speaker shall be measured.
4	Thermal Shock Test	<p>After being placed in a chamber at $+60 \text{ }^\circ\text{C}$ for 1 hour, then speaker shall be placed in a chamber at $-20 \text{ }^\circ\text{C}$ for 1 hour(1 cycle is the below diagram).</p> <p>After 4 above cycles, speaker shall be measured after being placed in natural condition for 10 Sec.</p>  <p>The diagram shows a temperature profile starting at $+60 \text{ }^\circ\text{C}$ for a 1-hour dwell. A green arrow indicates a 20-second ramp down to $-20 \text{ }^\circ\text{C}$, followed by a 1-hour dwell at the lower temperature.</p>
5	Vibration Test	After being applied vibration of amplitude of 1.5mm with 10 to 55Hz band of vibration frequency to each of 3 perpendicular directions for 1 hour, then placed in natural condition for 1 hour, speaker shall be measured.
6	Drop Test	The speaker when mounted in the jig which weight 85g~100g, shall with stand 15 times random drops from a height of 1.5 meter to a concrete floor faced with 5mm thick hard wood board.and be nothing mechanical damage.
7	Load test	After being applied loading white noise with input power 0.5W(5Vrms.) for 96 hours, then placed in natural condition for 1 hour, speaker shall be measured.
8	Insulation test	When they are measured with DC 100V the insulation resistance between v.c. terminal and frame must be more than $1 \text{ M}\Omega$

5. Measurement Block Diagram & Response curve

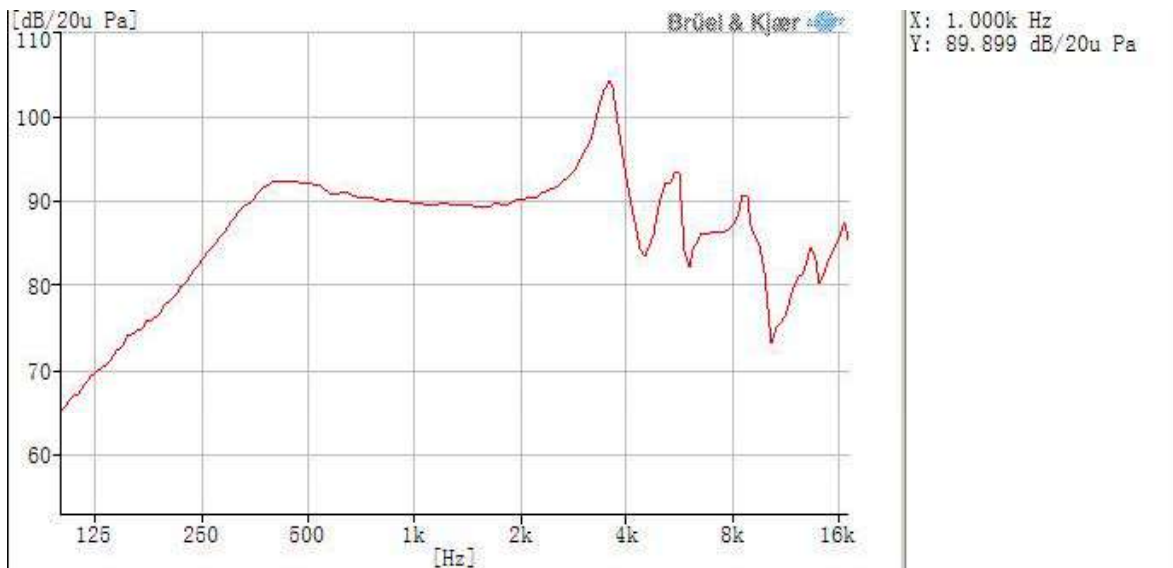
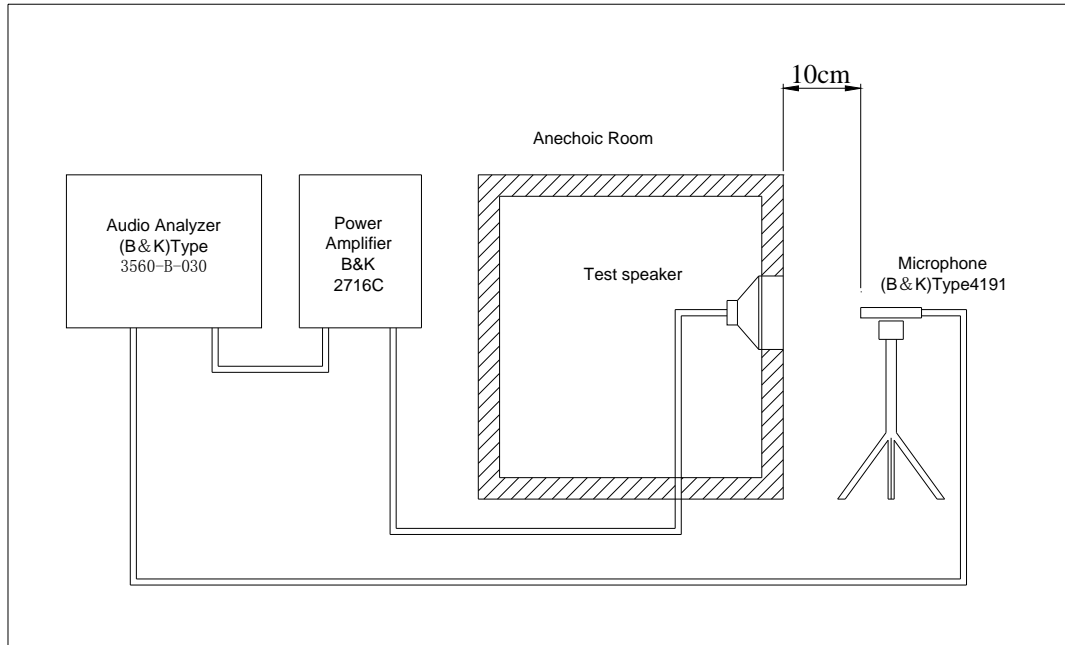

Specification for Speaker

Page

6/9

Revision No.

1.1

Model No. : KP5075SP1R50-7561

Drawing No.

KFC7561

6. Structure

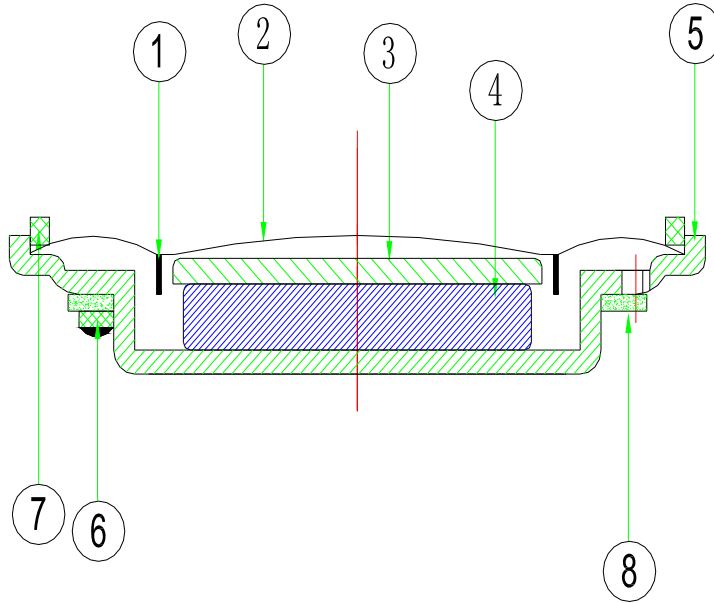

8	Screen	1	unwoven fabric	
7	Gasket	1	Paper	
6	Terminal	1	Epoxy PCB	
5	Frame	1	SPCC	
4	Magnet	1	Nd-Fe-B	
3	Plate	1	SPCC	
2	Diaphragm	1	PET	
1	Voice Coil	1	Copper	
No.	Part Name	Q'ty	Material	Remarks

Specification for Speaker

Page

7/9

Model No. : KP5075SP1R50-7561

Revision No.

1.1

Drawing No.

KFC7561

7. Dimensions

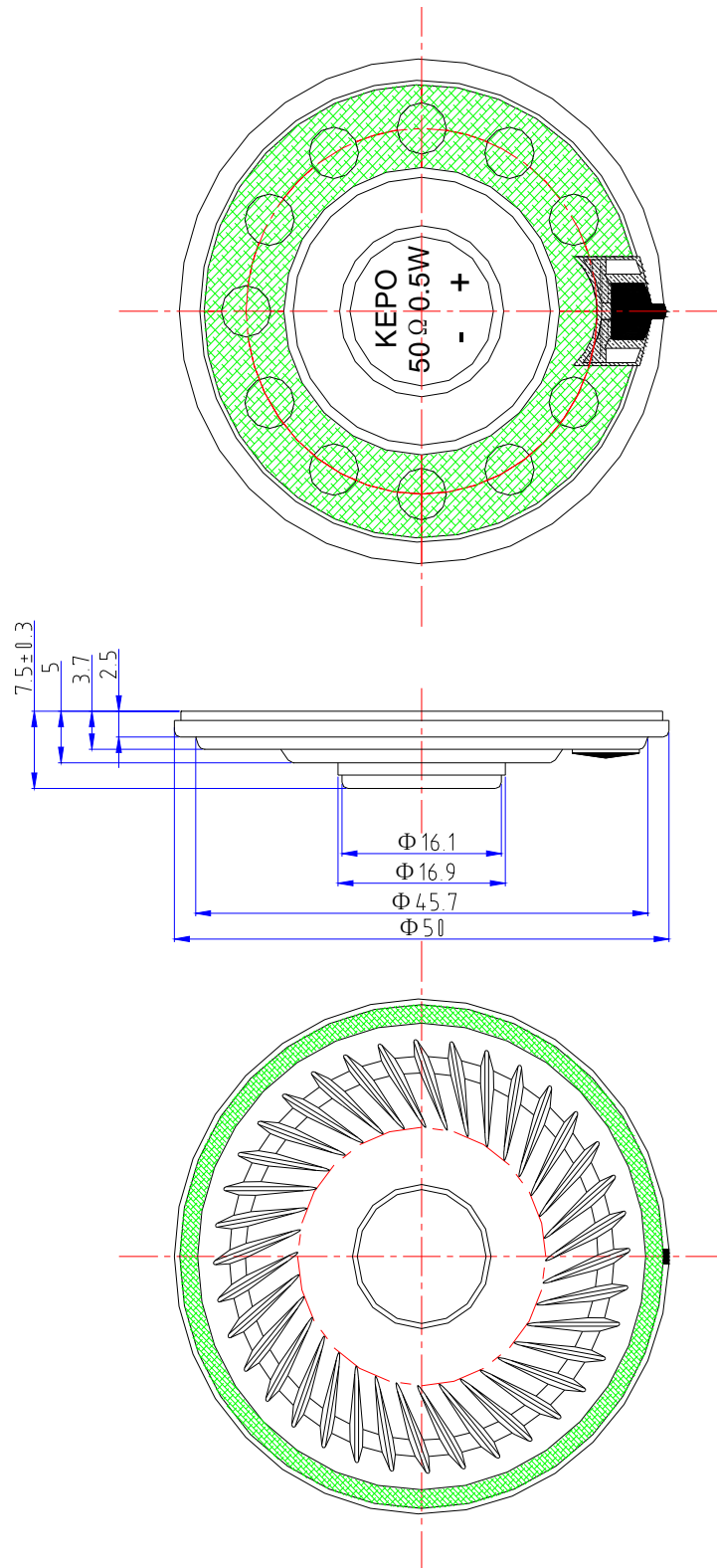

FIRST ANGLE PROJECTION

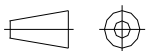

UNIT : mm

Tolerance : ± 0.2

8. Packing

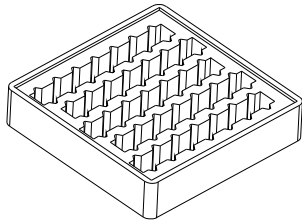
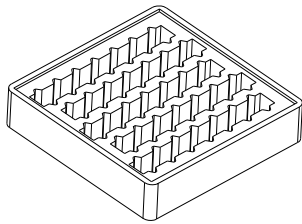

70Pcs/Tray
335x335x70mm

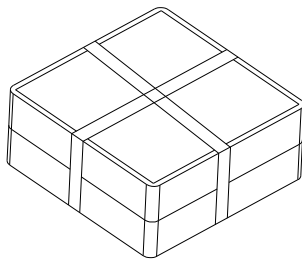

140Pcs/2Tray
335x335x70mm

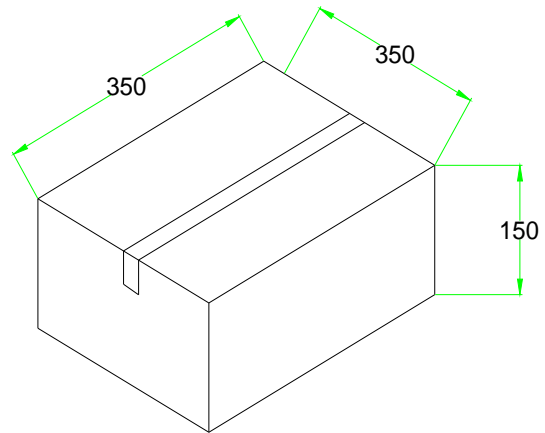
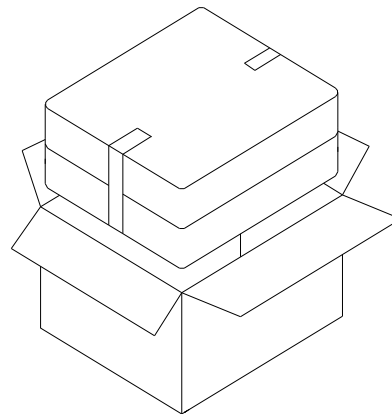

2Trays/Carton(140pcs)
350x350x150mm

